

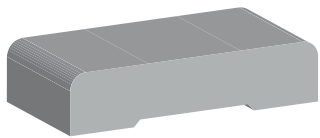

**Boise Cascade®**  
MILLWORK

# DENVER MILLWORK MOULDINGS

## CASING-BULLNOSE



413  
11/16" X 3-1/4" X 17'



473  
9/16" X 2-1/4" X 17'

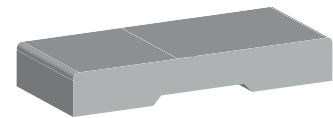

494  
1/2" X 3-1/4" X 17'

## BASE-BULLNOSE



433  
1/2" X 3-1/4" X 16'



603  
1/2" X 5" X 16'



803  
1/2" X 7-1/4" X 16'

## ANDERSEN



346  
9/16" X 2-1/4" X 17'

## COLONIAL



623  
1/2" X 3-1/4" X 16'

## 1X BOARDS



- |                              |                                |
|------------------------------|--------------------------------|
| 1X2<br>11/16" X 1-3/4" X 16' | 1X6<br>11/16" X 5-1/2" X 16'   |
| 1X3<br>11/16" X 2-1/2" X 17' | 1X8<br>11/16" X 7-1/4" X 16'   |
| 1X4<br>11/16" X 3-1/2" X 16' | 1X12<br>11/16" X 11-1/4" X 16' |

[millwork.bc.com](http://millwork.bc.com)

11011 E 104th Ave, Suite 1000  
Commerce City, CO 80640  
720-653-3333  
DenverMillwork@bc.com